

14 Roger Street Lot 39 DPS 17385 Section Block

ROTORUA CITY COUNCIL

Plumbing & Drainage to New Dwelling

Owner: Peerless Homes Ltd

Plumber: S. Francis

Drainlayer: J.M. Culmer



BC

Valuation No.: 655/947pt

Permit No.: 5316 & 5317

Appn No.: 4053 & 4054

INSPECTIONS

23-1-75

Date

23-6-75.

Plumbing Inspection. Drainage Inspected and Tested. all fixtures
installed. Plumbing Complete.
Series Inspection





CITY OF ROTORUA

Valuation No.

4053
4054
655/947^{PT}

APPLICATION FOR PERMIT TO CARRY OUT SANITARY PLUMBING AND DRAINAGE WORK

I, the undersigned, hereby apply for permission to have the work described herein and set out on the plans attached hereto, carried out in accordance with the provisions of the Drainage and Plumbing Regulations 1959 at premises situated at:

Address 14 ROGER ST. ROTORUA

Legal Description:

Lot No. 39Deposited Plan No. 17385

Section No. _____ Block No. _____

Description of Work: PLUMBING & DRAINAGE WORK TO SINGLE PRIVATE DWELLING

Name and address of Person for whom work is to be carried out:
PEARLESS HOMES LTD BOX 887 ROTORUA

Name and address of Registered Plumber: S. FRANCIS 39 WARD AVE ROTORUA

Name and address of Registered Drainlayer: J. CULMER 10 MCDOWELL ST. ROTORUA
ROTORUA

PLUMBING	600	8.00
DRAINAGE	300	6.00
TOTAL . . .	900	\$14.00

Signature: [Signature]Date: 18-11-74

Value of Work including Materials:

Plumbing: \$ _____
 Drainage: \$ _____
 Total: \$ _____
 Fee Enclosed: \$ _____

See reverse for Fees and Notes.

FOR OFFICE USE ONLY

Date Received _____

Fee Paid \$14.00 R14267ADate Paid 22-1-75Issue Approved [Signature]Date Approved 25-11-74Permit No. 5316 & 5317Date Issued 22/1/75

FOR OFFICE USE ONLY

FEE PAYABLE ON THE ISSUE OF ANY PLUMBING OR DRAINAGE PERMIT

according to the Estimated Value of Work

Value of work (including value of fittings)

Dollars	Dollars
up to 100	1.50
101 - 200	3.00
201 - 400	6.00
401 - 600	8.00
601 - 800	10.00
801 - 1000	12.00
1001 - 1200	14.00
1201 - 1400	16.00
1401 - 1600	18.00
1601 - 1800	20.00
1801 - 2000	22.00

2001 and over, 1 dollar extra for every \$200 or part thereof in excess of 2000 dollars.

IMPORTANT

INSPECTION & TESTING REQUIREMENTS

Drainage Work: Drainlayers are required to notify the Plumbing and Drainage Inspector when all work is completed. This includes effluent disposal systems for septic tanks. All drains will be tested with a 5ft head of water. To implement this test it will be necessary for persons undertaking drainage work to have sufficient drain plugs to fill all sections of the drain prior to the Plumbing and Drainage Inspector arriving on the job, also to have available a stand pipe to apply the 5ft head pressure.

This form of testing is essential to exclude the possibility of ground water infiltration with its attendant increase in pumping charges and overloading of the sewers and treatment plant.

Plumbing Work: Plumbers are required to notify the Plumbing and Drainage Inspector when work is ready for inspection as follows:

- When the building has been initially piped out and wastes are installed (before wall linings are fixed and floors laid).
- When work is complete.

Plans of Drainage and Plumbing work:

In the case of single houses a preliminary drainage plan will not be required. In all other cases, however, plans of the preliminary proposal are to be submitted at the time of application for a permit. In all instances, however, an "as laid" plan must be available on site as a prerequisite to a test of the work.

In commercial buildings full plans and elevations of plumbing stacks must be provided at the time of application for a permit.

Plans MUST show figured dimensions
and distances from section boundaries

Rotorua City Council

DRAINAGE PLAN

SCALE: IN. TO A FOOT

NEW SEWERAGE DRAINS—RED
STORMWATER—DOTTED BLACK
OLD DRAINS—FULL BLACK

655/947PT

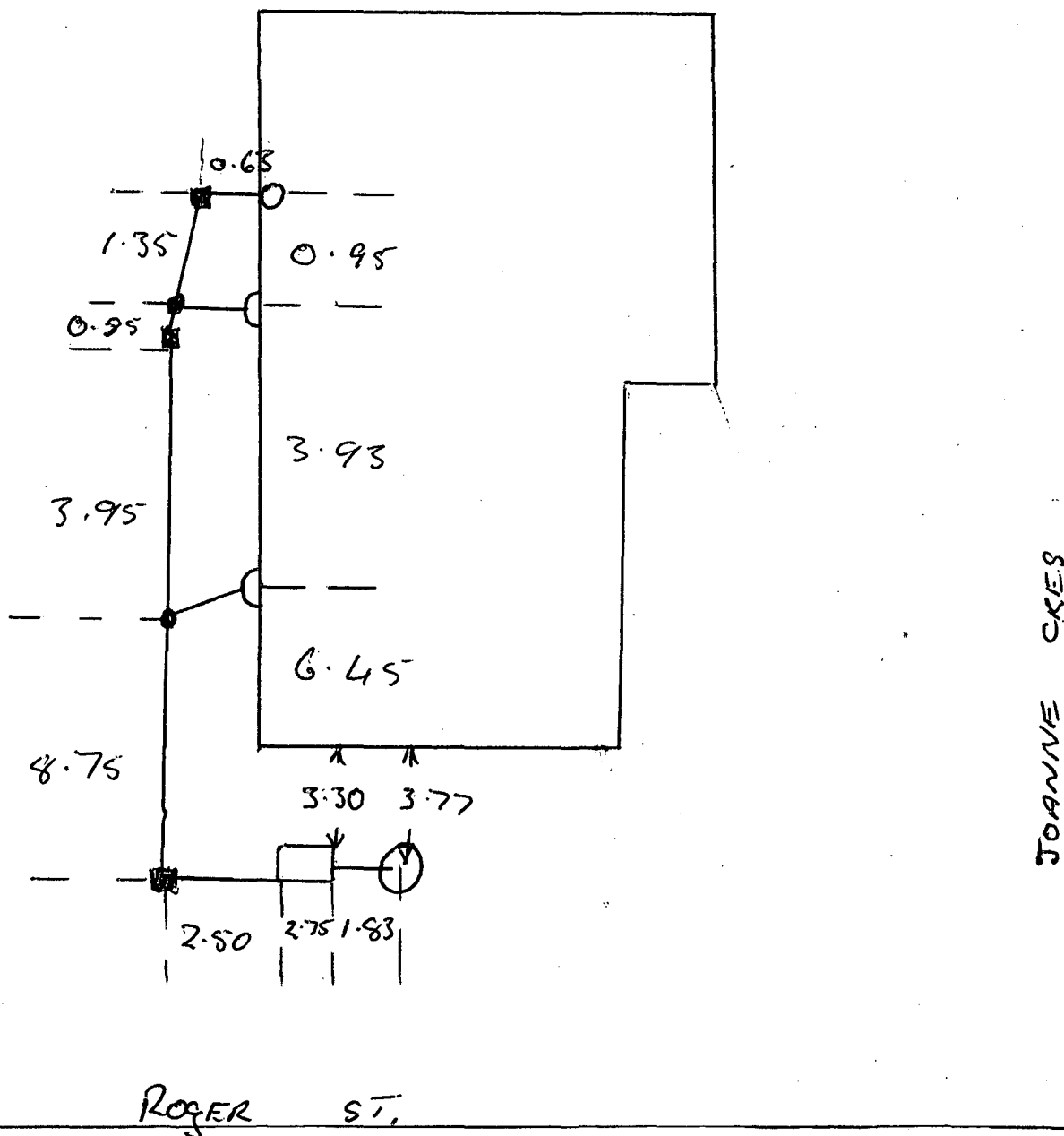

OWNER PEARLESS HOMES LTD

No. 14 STREET ROGER ST

LOT 39

SEC. _____

BL. _____

SIGNATURE

OF DRAINLAYER

[Signature]

DATE

23/6/75